

95 95

Adams Broil
1500 Acres

Ed
100 to com
amble 14 Nov
1799

2229
#2229

James Garrard Esq: Governour of the Commonwealth of Kentucky to all to whom
 these Privats shall come greeting, Knowye, that by virtue and in consideration
 of our Lord Office Treasury Warrants N^o 587, 588, 590, and 591. there is granted
 by the said Commonwealth unto Adams Broil a certain tract or parcel of land
 containing fifteen hundred acres by survey bearing date the seventeenth day of
 August one thousand seven hundred and ninety seven lying and being in
Mickson County on the middle fork of Rockcastle. and bounded as followeth
 To wit Beginning at three Linn two Poplars, and a Sugar tree, standing on the
 East side of Rockcastle, three Quarters of a mile above the trees from the
 Settlement to Bonsborough running from thence North 45 East 600 Poles
 crossing Rockcastle four times to three Poplars, from one root & two white
 Oaks, thence South 45 East 400 Poles, to a Linn and two Sugar trees,
 standing on the bank of Blackoon creek, thence South 45 West 600 Poles
 to three Sugar trees, two white Oaks, and a poplar on the bank of a creek
 thence North 45 West 400 Poles to the Beginning

With its Appurtenances To have and to hold the said tract or parcel of
 Land with its Appurtenances to the said Adams Broil and his Heirs forever
 In witness whereof the said James Garrard Esq: Governour of the Common-
 wealth of Kentucky hath hereunto for his hand & caused the seal of the
 Commonwealth to be affixed at Frankfort on the fifteenth day of
 May in the year of our Lord 1796 and of the Commonwealth the sixth
 L. J. P. of the Governour

James Garrard.

Henry Paulding Secy

Madison Jct
 Augth 17. 1797.

Surveyed for Adam Brind
 1500 acres of land upon
 four Treasury warrants
 N^o. 587 - 588 - 590 &
 591 - lying on the mid-
 dle fork of Rockcastle
 Bounded as followeth (to wit)
 Beginning at three Lynns
 two poplars and a Sugar tree
 at A Standing on the East
 Side of Rockcastle three

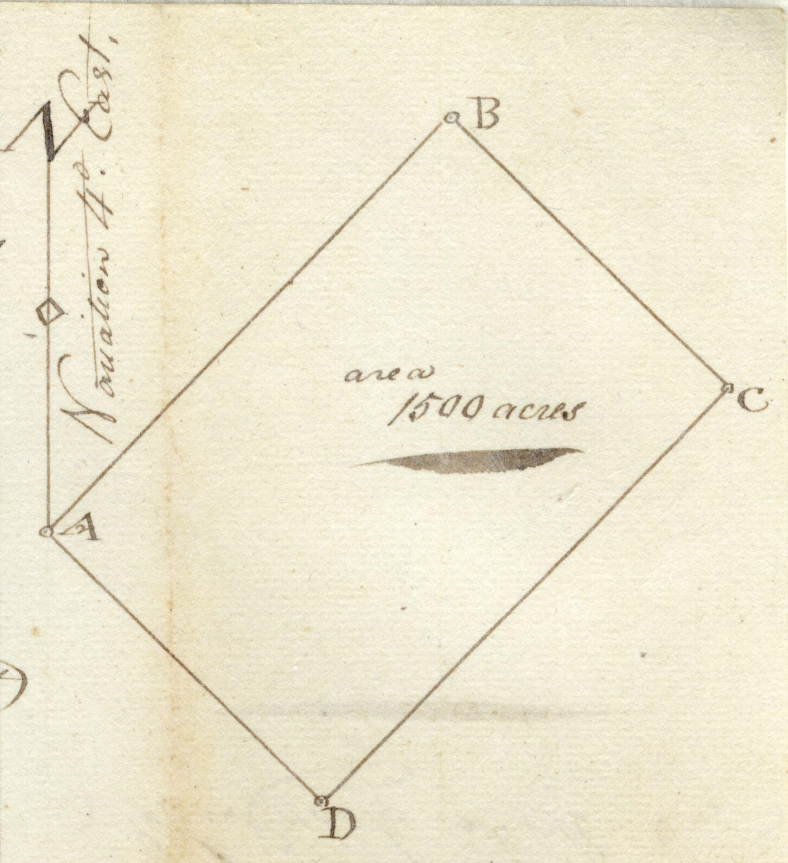

Scale 200 p^o to the Inch - - -

Quarters of a mile above the trace from the Settlement to
 Moonsborough running from thence N45°E 600 poles crossing
 Rockcastle four times to three poplars from one root
 and two white Oaks at B. thence N45°E 400 poles
 to a Lynn and two Sugar trees Standing on the bank
 of Racoon creek at C. thence N45°E 600 poles to three
 Sugar trees and two white oaks and a poplar at D. on the
 bank of a Creek thence N45°E 400 poles to the Be-
 ginning -

Charles Carter } b.c.
 Wm Wallace }
 Wm Trimble marker

Daniel Boone D.S.

Es. John Brooke S. M. C.

The Indenture upon which the within Survey was made
bears date May 15th 1780, John Brooke & Co.

Adam Broil's

Attatt of Certificate

for 1500 acres

Co. of Rec. of Ex.

N 2229

Rec^d 12th Oct 97

Recorded in Book 4 folo

280

4-180

2229

15th May 98

Land-Office Treasury WARRANT, N^o 591

To the principal Surveyor of any County within the Commonwealth of Virginia.



THIS shall be your WARRANT to Survey and lay off in one or more Surveys, for *Adam Brail*

his Heirs or Assigns, the Quantity of *Six Hundred and* Acres of Land, due unto the said *Adam Brail*

in Consideration of the Sum of *One Hundred Forty pounds* current Money paid into the publick Treasury; the Payment whereof to the Treasurer hath been duly certified by the Auditors of publick Accounts, and their Certificate received into the Land Office. GIVEN under my Hand, and the Seal of the said Office, on this *fifteenth* Day of *October* in the Year One Thousand Seven Hundred and *Seventy Nine*

John Hawke Secy. of Off